

# HOBIE WAVE

## WAVE VERSION NOTES:

**STANDARD WAVE / CLASSIC OR "SE"** - (CAR TOPPABLE) ONE PIECE TRAMPOLINE, SHROUDS AND BRIDLES CONNECT WITH HOOKS

**CLUB WAVE** -THREE PIECE TRAMPOLINE. SHROUDS AND BRIDLES CONNECT WITH CLEVIS PINS

*CLUB items listed only if different from standard SE wave model.*

## CLASSIC / SE WAVE

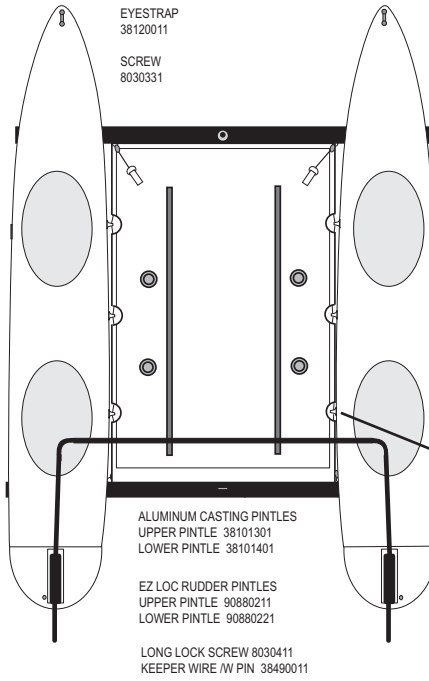

### REPLACEMENT HULL (W/O GRAPHICS)

PORT/LEFT 39010001  
STARBOARD/RIGHT 39020001

SEAT PAD  
PURPLE 38010051  
LT BLUE 38010061

PORT COVER (UNDER SEAT PAD)  
38370001  
SCREW (NEWER MODELS AND RETROFITS)  
8031950

CHAIN PLATE 39100011  
SCREW 8030331

INSERT CAP  
38120031

OLDER -  
TRAMPOLINE ANCHOR HOOK 38760031

NEWER- (BOATS WITH TRACKS)  
TRAMP TENSION SLIDE 38760071

DRAIN PLUG W/GASKET  
91281000  
AFTER S/N 1973 USE  
10091000

**39522001 NEW TENDON STYLE**  
TILLER CONNECTOR UPGRADE  
INCLUDES TILLER CROSS BAR AND ALL  
TILLER CONNECTOR FITTINGS

FOR EARLY BOATS WITH CURVED  
TENDON CONNECTORS:  
TILLER CONNECTOR UPGRADE 1954\*

**\*1954 TILLER CONNECTOR UPGRADE**  
INCLUDES TILLER CROSS BAR AND ALL  
TILLER CONNECTOR FITTINGS

### '97-NEWER

(SN 1438-ABOVE)  
FORWARD CROSSBAR 38131041

MAST STEP CASTING 38170011  
POST (THREADED) 38170001  
BALL 50212301  
BASE STEP PIN 8020451

### '96-OLDER

MAST STEP CASTING 10170011  
MAST STEP LINK KIT 21380001

FORWARD  
END CAP 38130031

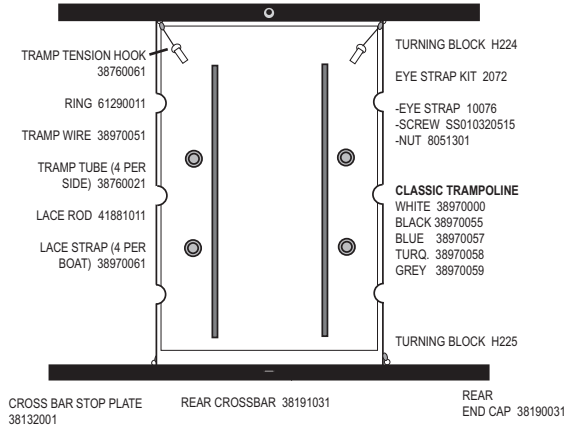

### ACCESSORY PARTS

BOW SPREADER 38999021  
END CAP 38960011  
SPREADER TANG 38120041

SEAT BACKREST 38040011  
QUICK PIN 8020181

BACKREST PLUG, FORWARD 38660011  
BACKREST PLUG, AFT 38660031

## CLUB WAVE

( CLUB WAVE VERSION-ITEMS LISTED BELOW ONLY IF DIFFERENT FROM STANDARD WAVE MODEL. )

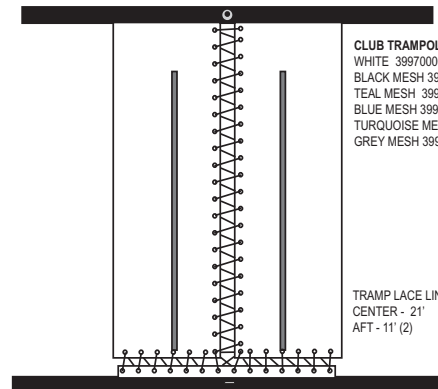
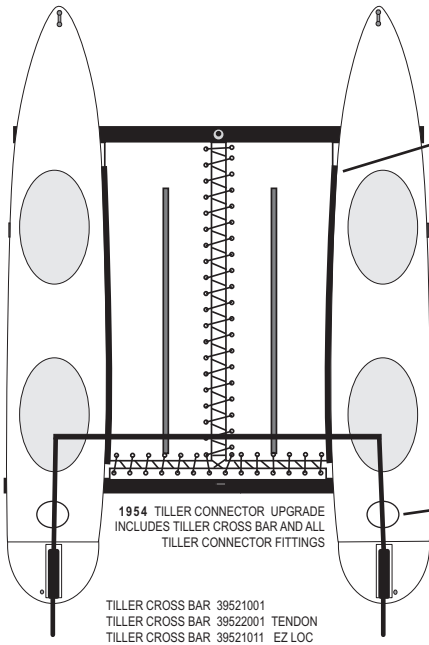

**EZ LOC RUDDER ASSEMBLY**  
39312000

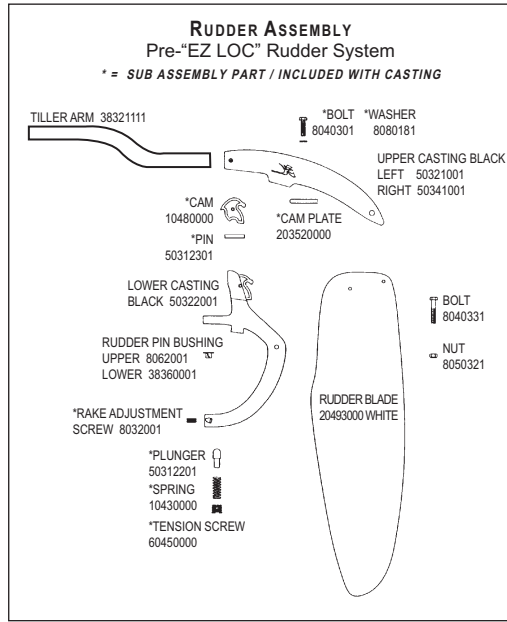
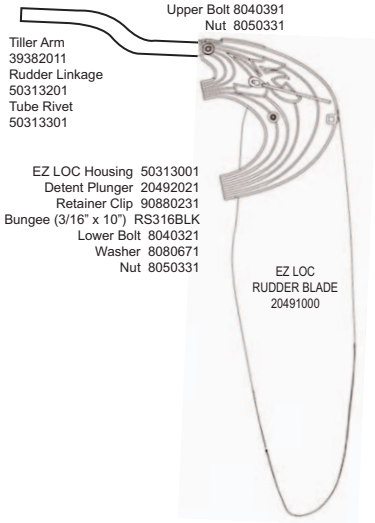

**39522001 NEW TENDON STYLE**  
TILLER CONNECTOR UPGRADE  
INCLUDES TILLER CROSS BAR AND ALL  
TILLER CONNECTOR FITTINGS

**TENDON TILLER CONNECTOR ASSEMBLY**

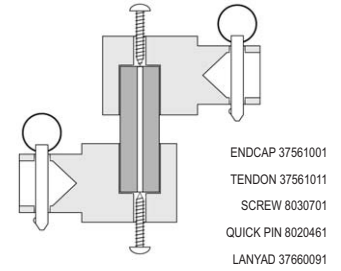

**1954 TILLER CONNECTOR UPGRADE**  
INCLUDES TILLER CROSS BAR AND ALL  
TILLER CONNECTOR FITTINGS

**1954 CLUB TILLER END CAP ASSEMBLY**

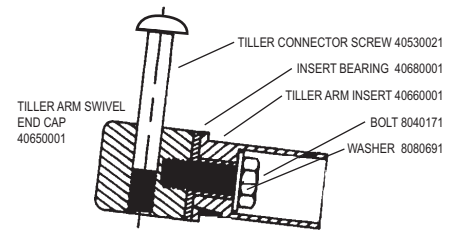

- BATTEN #5 36"
  - BATTEN #4 50"
  - BATTEN #3 66 7/8"
  - BATTEN #2 77 7/8"
  - BATTEN #1 82 3/8"
- 38016001 HOBIE WAVE BATTEN SET  
(FOR INDIVIDUAL BATTENS SEE UNIVERSAL BATTENS ON PAGE 18)

**MAST**

**SERIAL NUMBER 0 THROUGH 1437**  
OLD ASSEMBLY NLA (SEE NEW STYLE BELOW) CONVERSION REQUIRES  
MAST STEP RETROFIT.  
MAST BASE (HOBIE14 STYLE)  
10640011

**SERIAL NUMBER 1438 AND NEWER**  
MAST ASSEMBLY (NEW STYLE)  
38581041  
LOWER MAST 38583141  
NEW MAST BASE (CUP) 38641001

**MAST STEP PARTS**  
(\*Conversion parts required to retrofit new mast to old style boat):  
\*NEW STEP BALL 50212301  
\*NEW STEP POST 38170001  
\*NEW MAST STEP CASTING 38171001 (Flat top / threaded for post)  
\*RIVET (4) 8011231  
\*STEP PIN 8020451

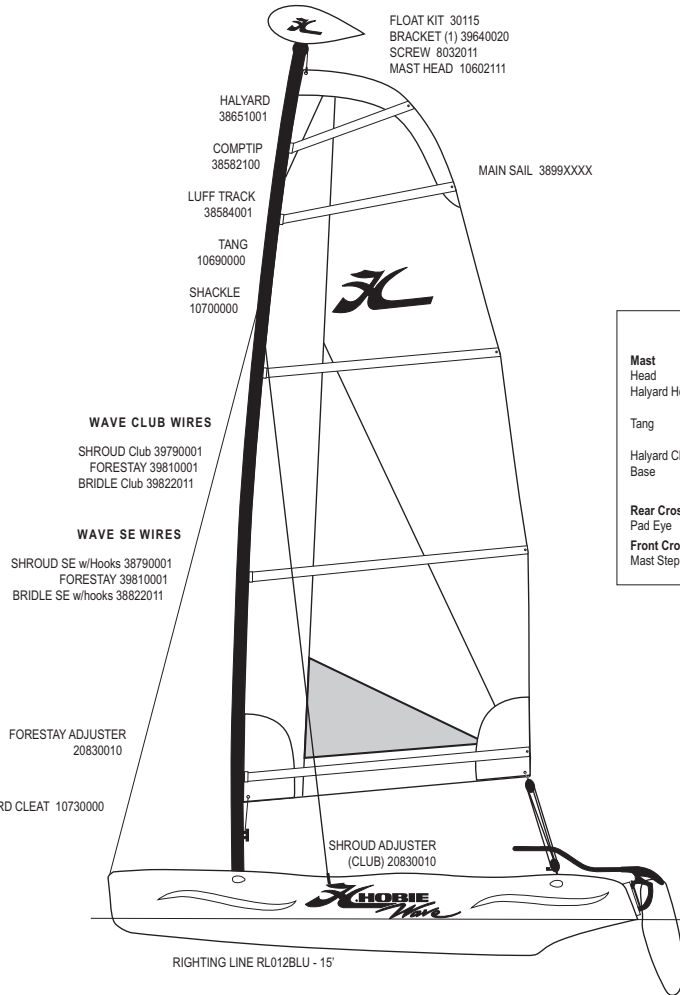

**Wave Rivet Guide** ( ) Quantity needed to fasten part

<b>Mast</b>		<b>Rudder Assembly</b>	
Head	8010131 (2)	Upper Casting	8010131 (2)
Halyard Hook	8010181 (2)	(Underside)	8011231 (1)
	8011291 (2)	Tiller End Cap	8010131 (2)
Tang	8010181 (6)		
	8011291 (6)	<b>Sail</b>	
Halyard Cleat	8010121 (2)	Headboard	8010020 (16)
Base	8010131 (3)	Tack/Clew plate	8010020 (6)
		Pocket Protector	8010020 (4)
<b>Rear Crossbar</b>		(Requires setting machine-not available as hand tool)	
Pad Eye	8010181 (2)		
<b>Front Crossbar</b>			
Mast Step	8011231 (4)		

